

Artikel-Bezeichnung: HYDES1D

**Technische Daten:**

Umgebungstemperatur:	-20°C bis +60°C
Nennspannung/ Nennstrom:	250 VAC / 16 A
Anschlussart:	Schraubanschluss berührungssicher
Anzugsdrehmoment :	0,6 Nm
Anschluss-Art :	massiv oder flexibel
Abisolier-Länge:	7mm
Anschluss-Querschnitt:	max. 2,5mm ²
Anzeige:	LED (Grün)
Steckdose Material:	PA66, UL94 V-0, RoHS-konform
Steckdose Farbe:	grau, RAL 7035
Beschriftungsschild:	ES1D-M1(10Stk)
Normen :	DIN 49440-1 DIN VDE0626-1:2010-02 Niederspannungsrichtlinie 2014/35/EG

Zulassungen:

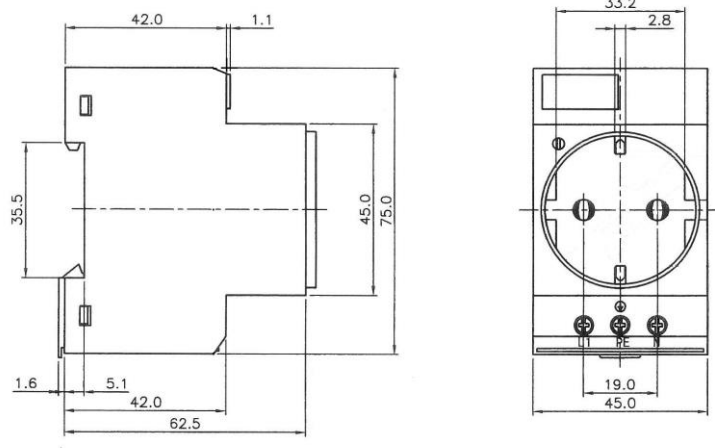

VDE-Ausweis-Nr. 40029547

Abmessungen**Maßeinheit: mm**

(Ansicht von Oben)

Länge: 75mm

Breite: 45mm

Höhe: max. 65,6mm

Zubehör

Beschriftungsschild – 10 fach

Type: ES1D-M1 (10 Stk.)

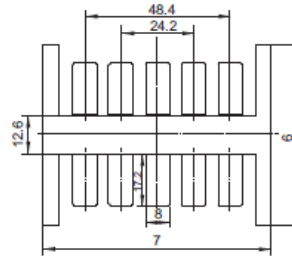

Abmessungen

Maßeinheit: mm

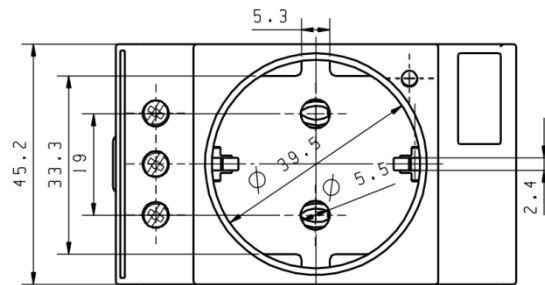
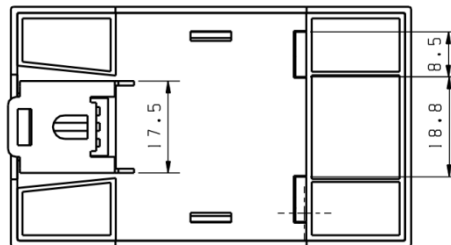
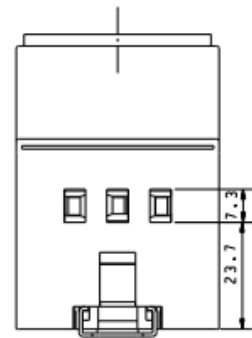
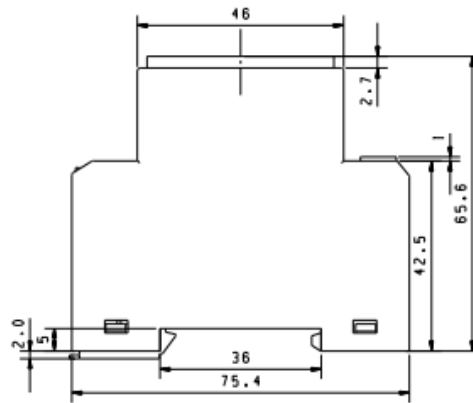
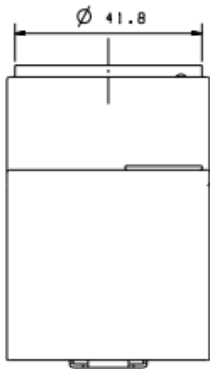

Disclaimer

This datasheet is for the customers' reference. All the specifications are subject to change without notice. We could not evaluate all the performance and all the parameters for every possible application. Thus the user should be in a right position to choose the suitable product for their own application. If there is any query, please contact Hongfa for the technical service. However, it is the user's responsibility to determine which product should be used only.

© Xiamen Hongfa Electroacoustic Co., Ltd. All rights of Hongfa are reserved.

